

DO NOT SCALE  
ENE Elevation

- NOTES
- All levels are to existing, unless otherwise stated.
  - The site is to be used for the purposes of the proposed development.
  - The site is to be used for the purposes of the proposed development.
  - The site is to be used for the purposes of the proposed development.
  - The site is to be used for the purposes of the proposed development.
  - The site is to be used for the purposes of the proposed development.
  - The site is to be used for the purposes of the proposed development.
  - The site is to be used for the purposes of the proposed development.
  - The site is to be used for the purposes of the proposed development.
  - The site is to be used for the purposes of the proposed development.

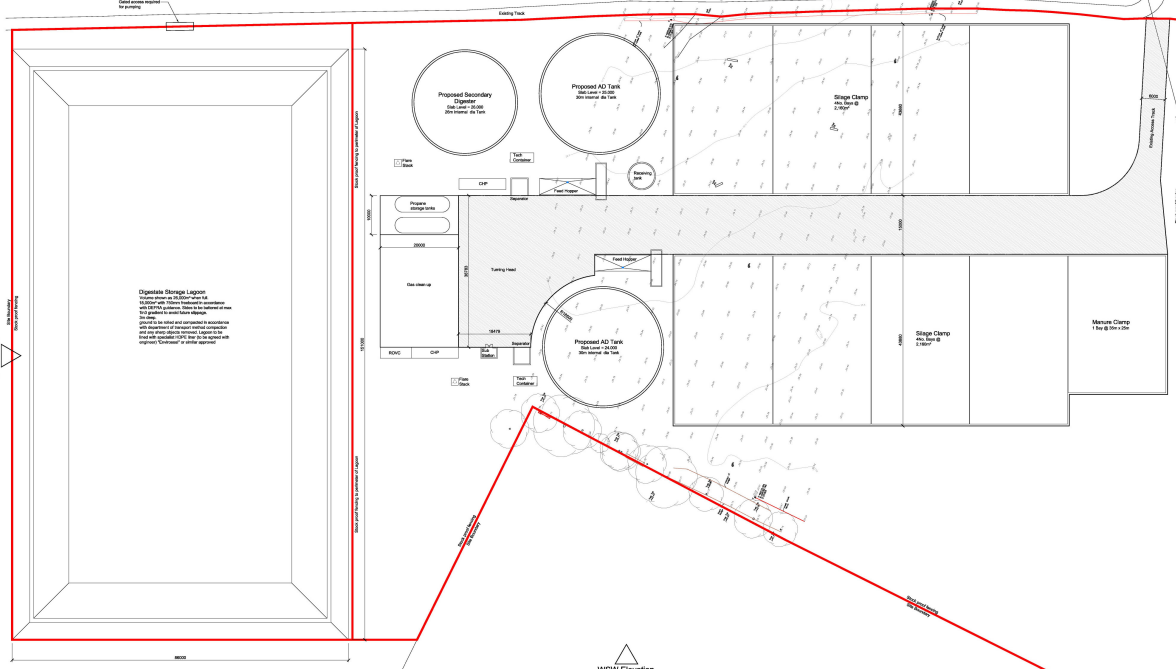

Operational Storage Layout  
This plan shows the layout of the proposed storage areas for the proposed development. The layout is based on the site plan and the proposed development. The layout is subject to change and should be used as a guide only.

DATE VALID  
30/9/14

Item	Date	By	For
Client Information	01/05/14	SG	ADP
Design Information	01/05/14	SG	ADP
Check Information	01/05/14	SG	ADP
Issue Information	01/05/14	SG	ADP
Final Information	01/05/14	SG	ADP

JFS & Associates  
147661-100

Client:  
Crestal Pfl Farm  
ADP Plant  
Sand Hutton

Drawing Title:  
Proposed Site Plan

Drawn:  
S. Ramshaw  
Date:  
May 2014

Scale:  
1:400  
Original Size:  
A2

Billinghurst George & Partners  
147661-100  
147661-100

To reproduce others this drawing constitutes a copy without permission. Billinghurst George & Partners will not be held liable for any errors or omissions in this drawing. 147661-100 Rev P7

This plan has been checked by an authorised person and is correct as shown. It is intended for use as a guide only and should not be used for any other purpose. The client is responsible for the accuracy of the data provided.